

# QCFC-B / QCFCH-B LOCKING RECEPTACLES

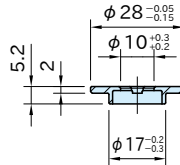

**QCFC0628-B-SUS**

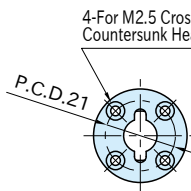
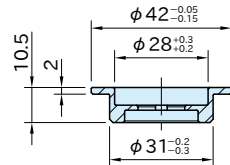
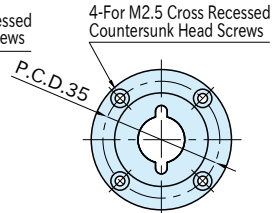

**QCFC0639-B-SUS**

Part Number	Plate Thickness	Weight (g)	Flat Quarter Turn Clamps
<b>QCFC0628-B-SUS</b>	6 or more	8	<b>QCFC0628-SUS</b>
<b>QCFC0639-B-SUS</b>		32	<b>QCFC0639-SUS</b>

<b>Body</b>
SUS303 stainless steel

## Supplied With

4 of cross recessed countersunk head screws (stainless steel), M2.5X0.45-5L

## Reference

"Accuracy" of [QCFC](#) / [QCFCH](#) Flat Quarter Turn Clamps

## Installing Position

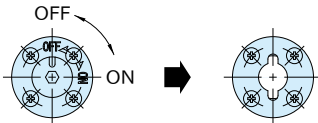

**QCFC0628-SUS**

**QCFC0628-B-SUS**

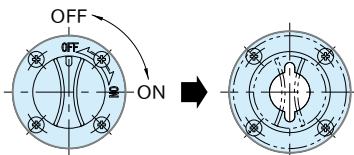

**QCFC0639-SUS**

**QCFC0639-B-SUS**

Please note the orientation of Locking Receptacle to Flat Quarter Turn Clamp.

## How To Install

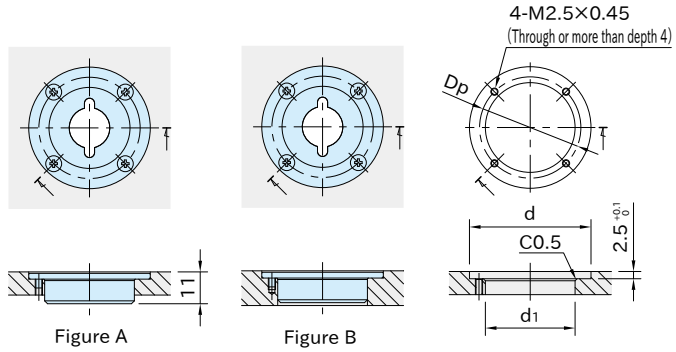

Part Number	Plate Thickness	Figure	d ( $\begin{smallmatrix} +0.05 \\ 0 \end{smallmatrix}$ )	d <sub>1</sub> ( $\pm 0.1$ )	D <sub>p</sub>
<b>QCFCH0628-B-SUS</b>	6 or more	B	28	17	21
<b>QCFC0639-B-SUS</b>	6 or more, under 12 *)	A	42	31	35
	12 or more	B			

\*) With thin plates, the bottom of the locking receptacle protrudes from the plate.