

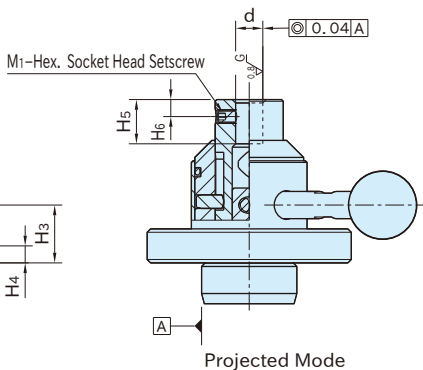

Body	Piston	Handle	Ball Knob
Steel (S45C) Quenched and tempered Black oxide finish	Steel (SCM440) Quenched and tempered Black oxide finish	Steel (SCM435) Black oxide finish	ABS resin Black

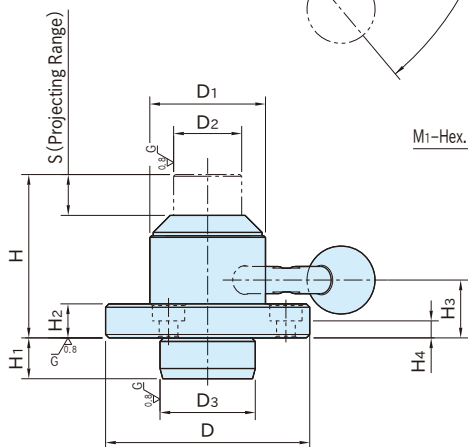
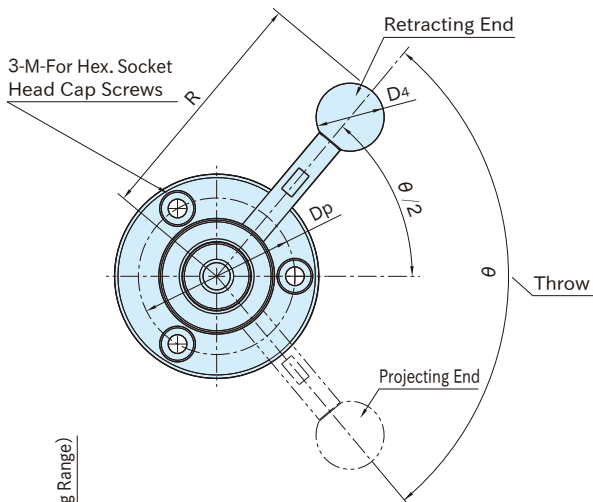

Part Number	d (G7)	D ₂	H ₅	H	S	D ₃ (g6)	H ₁	D	D ₁	H ₂	M	H ₄	D _p	R
CP700-20050R	8	20	13	48	12	28	12	60	34	10	M5	5	46	71
CP700-30063R	12	30	15	61	15	42	14	80	48	13	M6	7	63	94

Part Number	D ₄	H ₃	θ	M ₁	H ₆	Allowable Operating Load (N)*)	Max. Workpiece Weight (kg)**)	Weight (kg)
CP700-20050R	20	17	100°	M4×0.7-5L	5	150	250	0.42
CP700-30063R	25	23	90°	M6×1 -8L	8	200	300	1.04

*) Allowable load to operate the handle

**) Max. weight that allows the locating pin to project and provide workpiece centering

How To Use

Present Method

Galling and damage caused

Imao Method

No galling caused

Locating Guides

The locating pin gets projected only after the workpiece is set on supports. This allows loading and unloading the workpiece smoothly, with no galling.

Get the locating pin projected to locate the workpiece after it is roughly positioned with the help of locating guides.

Retracted Mode

Projected Mode

↔ Workpiece Centering

1. Rough Locating With Locating Guides
2. Pin Projection
↑ Pin Gets Projected
3. Completed Locating