

QLCP

CAM PUSH CLAMPS



Body	Piston / Pin	Cam Handle
S45C steel Black oxide finish	S45C steel Quenched and tempered Black oxide finish	SCM440 steel Quenched and tempered Black oxide finish

Counterclockwise Clamping

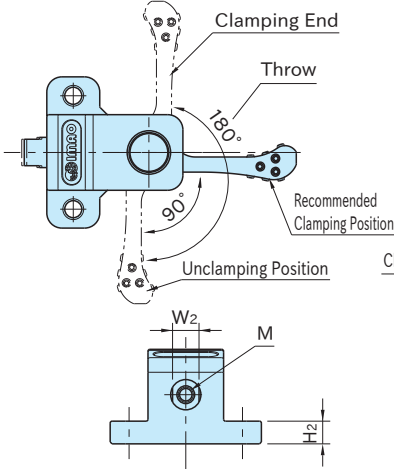

Clockwise Clamping

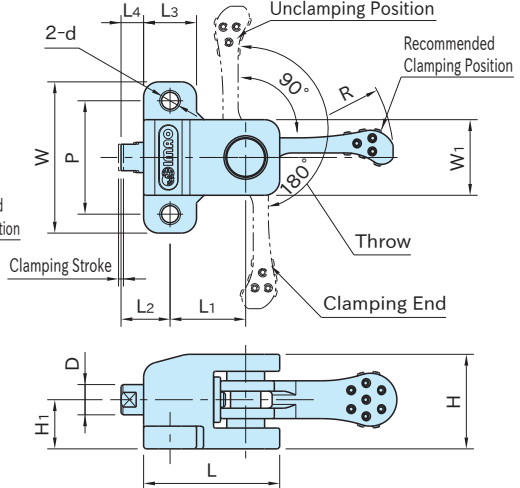

Part Number	Clamping Direction	Clamping Stroke	H ₁	D	W ₂	M	L ₂	L ₄	W	L ₃	H ₂	d	P	H	L	W ₁	R	L ₁	Cam Handle
QLCP080R	CW	1.2	13	8	7	M4X0.7 Depth 8	13	6	40	14	6	4.5	30	25	36	20	40	20	QLCA-04
QLCP080L	CCW																		
QLCP150R	CW	1.6	18	12	10	M6X1 Depth 12	19	9	55	20	10	6.6	40	33	50	26	63	28	QLCA-06
QLCP150L	CCW																		

Part Number	Allowable Operating Load (N) *	Clamping Force (kN)	Clamping Mechanism	Weight (g)
QLCP080R	80	0.9	Spiral Cam Cam Angle: 4°	130
QLCP080L				
QLCP150R	150	2.4		350
QLCP150L				

*) Allowable load to operate the cam handle

How To Use

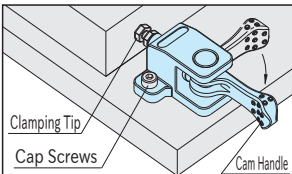

Turning the handle in the clamping direction lets the cam work to project the piston for clamping.

Turning the handle back lets the spring work to retract the piston for unclamping.

Performance Curve

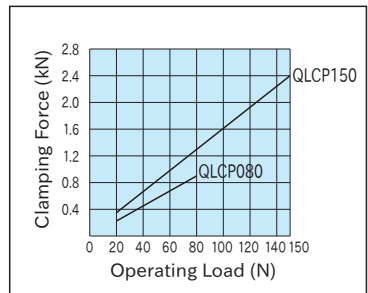

Feature

The tapped hole in the piston allows a tip to be fitted to the push clamp.