

# CP730

## ONE-TOUCH FLEX LOCATOR CLAMPERS (Hexagon Head)



**CP730-LH**  
(Tapered)

**CP730-SH**  
(Straight)

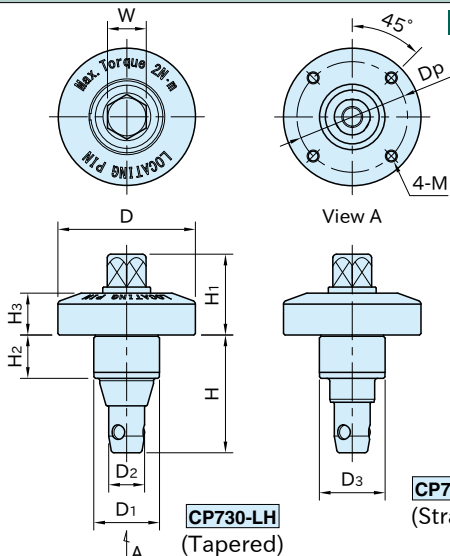

Body	Clamping Screw	Ball
SCM440 steel Nitrocarburized	SCM435 steel Black oxide finished Quenched & tempered	SUJ2 steel

Part Number	D <sub>1</sub> (g6)	D <sub>3</sub> (-0.02/-0.06)	H <sub>2</sub>	D	H <sub>1</sub>	H <sub>3</sub>	D <sub>2</sub>	H	W	M	Dp
<b>CP730-0939LH</b>	18	—	9.5	39	22	12	9	30	10	M4×0.7 Depth 6	30
<b>CP730-0939SH</b>	—	18									
<b>CP730-1246LH</b>	22	—	14.5	46	27	14	12	40	13		37
<b>CP730-1246SH</b>	—	22									
<b>CP730-1656LH</b>	28	—	19.5	56	34	16	16	51	17	M5×0.8 Depth 7	45
<b>CP730-1656SH</b>	—	28									

Part Number	Clamping Force (N)	Allowable Screw Torque (N·m*)	Weight (g)	Bushing
				CP735-0939L
<b>CP730-0939LH</b>	1700	2	134	CP735-0939S
<b>CP730-0939SH</b>			133	
<b>CP730-1246LH</b>	3000	4	241	CP735-1246L
<b>CP730-1246SH</b>			239	CP735-1246S
<b>CP730-1656LH</b>	4500	7	457	CP735-1656L
<b>CP730-1656SH</b>			453	CP735-1656S

\*)Do not apply greater torque than allowable screw torque.  
Do not use a power tool (impact wrench etc.) to turn the hex head, for damage prevention.

### How To Use

#### ■ Mounting Hole Dimension

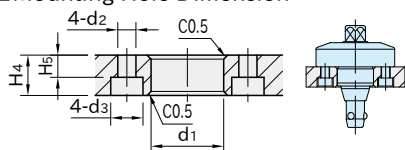

### Supplied With

- **CP730-0939**: Four pieces of hex. socket-head cap screws M4×0.7-10L
- **CP730-1246**: Four pieces of hex. socket-head cap screws M4×0.7-15L
- **CP730-1656**: Four pieces of hex. socket-head cap screws M5×0.8-20L

Size	d <sub>1</sub> (H7)	H <sub>4</sub> (±0.05)	d <sub>2</sub>	H <sub>5</sub>	d <sub>3</sub>
<b>CP730-0939</b>	18	10	4.5	5	8
<b>CP730-1246</b>	22	15		10	
<b>CP730-1656</b>	28	20	5.5	14	10

### Reference

How To Use ONE-TOUCH FLEX LOCATORS  
(Hexagon Head / Cam Handle)

### Related Product

**CP-TCW** ADJUSTABLE-TORQUE WRENCHES are available for tightening.